

How you can help!

Become a Member:

\$30 - Pine (Individual)

\$50 - Fir (Family)

\$100 - Spruce (Family Plus)

\$300 - Walnut (Best Friend)

\$500 and Up - Cedar (Sponsor)

If you own a business:

\$200 - Business

All the benefits below plus...

- Recognition in the Jewett Center & *Arborescent* newsletter.

Benefits Include.....

- The quarterly newsletter *Arborescent*.
- 10% discount in the Gift Shop.
- Class discounts.
- Advance notification of special events.
- Fir Member and Above - Benefits extend to your immediate family and Nature Day Camp Discount.

Dedicate a Memorial or Honorarium to a Special Friend or Loved One by...

- Engraving a brick in the Founders Courtyard. A perfect way to mark a special occasion.
- Planting a tree with a memorial plaque. A wonderful way to honor a loved one.

Give the Gift of Membership

We will send an acknowledgment of your gift to the recipient with a personal thank you letter.

Donate to the Arboretum's Endowment or General Fund

Your generosity helps to maintain the numerous gardens and trees as well as the events and classes that help create the Arboretum experience.

21 DOUGLAS-FIR, LARCH, & INCENSE CEDAR
Douglas-fir is of a different genus than that of the true firs. Larch needle-leaves are deciduous - i.e., larch is a deciduous conifer. A long border row of incense cedars stands as a windbreak, and a visual and sound barrier.

22 GINKGO
Another of the prehistoric species, this tree dominated the local landscape millions of years ago. Fossilized remnants are featured at Ginkgo-Wanapum State Park near Vantage on the Columbia River.

23 RAISED BED VEGETABLE GARDEN
In tending this garden, volunteers utilize Integrated Pest Management concepts, including beneficial insects, floating row covers, crop rotations, mulching, and plants resistant to pests, weeds and diseases. The beds are constructed of ~~plumber~~ or recycled durable plastic lumber. The trellises are built from recycled fruit tree props.

XERIC GARDEN DEMONSTRATION SITE

This project, adjacent east of the Jones Center, is sponsored by the WA State Department of Ecology & Yakima County Solid Waste. Xeriscape gardening is the planning and developing of a landscape that uses little additional water to maintain its environment. Notice the buffalo grass turf and the straw bale wall and arch.

HAROLD JONES NURSERY CENTER

The Jones Center is a service and maintenance facility for the gardener and work parties, and is home to the annual spring plant sale. Plans are in the works to turn the Jones Center into a GREEN demonstration building & Nature Center. The Arboretum's caretakers reside in the house nearby.

KARA KONDO DRYLAND GARDEN

Located in the parking lot south of the Jones Center is the Kara Kondo Dryland Garden. This garden demonstrates the use of water-wise plants for landscaping. The only moisture these plants receive is natural precipitation. Located toward the north end are native plants and adapted non-native plants, while cacti and succulents occupy the south end.

24 BEECH COLLECTION
Among the beeches, the contorted one shows well when snow covers the curving branches. Beeches have smooth gray bark, and produce edible nuts encased in prickly husks.

25 ROSE GARDEN, GAZEBO, & YELLOW GARDEN
The Rose Garden with its gazebo, pathway, benches, fountain, and memorials within the beds, is managed by the Lower Naches Garden Club and features 300+ roses. The Gazebo is available for smaller weddings. The nearby bed of yellow flowers is maintained by the Nature Artists Garden Club.

ORIENTEERING COURSE

The grid marker south of the flagpole near the Rose Garden also marks the start of the Orienteering Course. The Course is used by individuals and groups, such as Yakima County Search and Rescue, to hone compass navigation skills.

26 BLOSSOM FIREWORKS
In mid-April an explosion of ornamental fruit blossoms is infused with myriad white to pink to red tints of flowering cherry, plum, crabapple, pear, and peach.

27 NUT COLLECTION
This collection includes black walnut, English walnut, almond, Japanese heartnut and pecan.

28 MAPLE COLLECTION
Maples are noted for fall color, and range from large shade trees to small, shrubby accent trees. All have opposite leaves. The fruits are paired, winged seeds in doubles called samarae or keys.

29 UTILITY FRIENDLY TREES
These shorter-statured trees are suitable beneath overhead utility lines. A project of Pacific Power.

30 ENTRANCE TO THE ARBORETUM



Seasonal Highlights

December - January - February

Witch hazel, Red-osier dogwood, Hawthorn, Conifers

March - April

Cornelian cherry dogwood, Viburnum, Magnolia, Flowering cherry, plum, crabapple, pear and peach, Redbud, Flowering dogwood, Serviceberry

May - June

Hawthorn, Golden chain, Viburnum, Kousa dogwood, Yellowwood, wildflowers, cacti and succulents

September - October - November

Ornamental grasses, Nuts, Larch, Color foliage of deciduous trees, such as beech, birch, dogwood, ginkgo, maple, oak, sweetgum

HOURS

The Arboretum grounds are open every day of the year from dawn until dusk. There is no charge for admission. The **Tree House Museum Store** and **Interpretive Center** are open Monday - Saturday, 9 AM to 5 PM. To Schedule a group tour or to check out a **Fresh Science** backpack call **248-7337**.

Visit us on the web!
Keep up to date on the latest classes,
events and seasonal highlights.
Signup for the online newsletter at

www.ahtrees.org



Yakima Area Arboretum & Botanical Gardens

Self-Guided Tour



Welcome!

The Arboretum is a 'living museum' of over 1000 trees, together with other plant species of forbs, grasses and shrubs on 46 acres of land managed as display gardens and a natural area.

Established in 1967 by the Central Washington Federation of Garden Clubs, the Arboretum is a non-profit organization supported by the generosity of its members and through the hard work and dedication of its volunteers.

1 INTERPRETIVE CENTER
The tour begins at the Jewett Interpretive Center, a gift from Don & Helen Jewett of Yakima in 1992. Among its features are a carillon bell tower, The Heritage of Trees display, Fred & Dorothy Plath Solarium, Thomas G. Nielsen Herbarium, Tree House Museum Store, Founder's Courtyard & Rose Druse Pergola, Meeting facilities, kitchen, restrooms, & offices.

2 ROCK BORDER GARDEN
Near the Interpretive Center entrance is a rock border garden featuring native basalt rocks, low water use plants such as ornamental grasses, yarrows, rupeccias, sedums, and day lilies, and a columnar basalt memorial fountain.

3 COMPOST DEMONSTRATION SITE
Within the circle of arborvitae, the Yakima County Solid Waste compost demonstration site demonstrates a variety of compost bins for yard waste, worm composting, and pet waste. Look for more information inside the circle's mailbox.

4 POND & FOUNTAIN
Jewett Pond with its center fountain is framed by grasses, rushes, sedges, and red osier dogwood. Look for the blue heron, kingfisher, wood ducks, Canadian geese, & swallows that make this pond their home.

5 CENTENNIAL OAKS
This collection was first planted on Arbor Day in 1989 as part of Washington State's Centennial. There are now over 50 oak trees in the Arboretum's collection.

6 JOYFUL GARDEN
The Japanese Garden features a wisteria gateway, tea house, pagoda, reflecting pond and waterfall. It is a favorite and frequent site for weddings. Weeping Nootka false cypresses stand against the horizon at the garden's highest point.

7 MOUNTAIN ASH GROVE
The grove east of the Joyful Garden shows mountain ash along with hornbeam, honey locust, ash and birch.

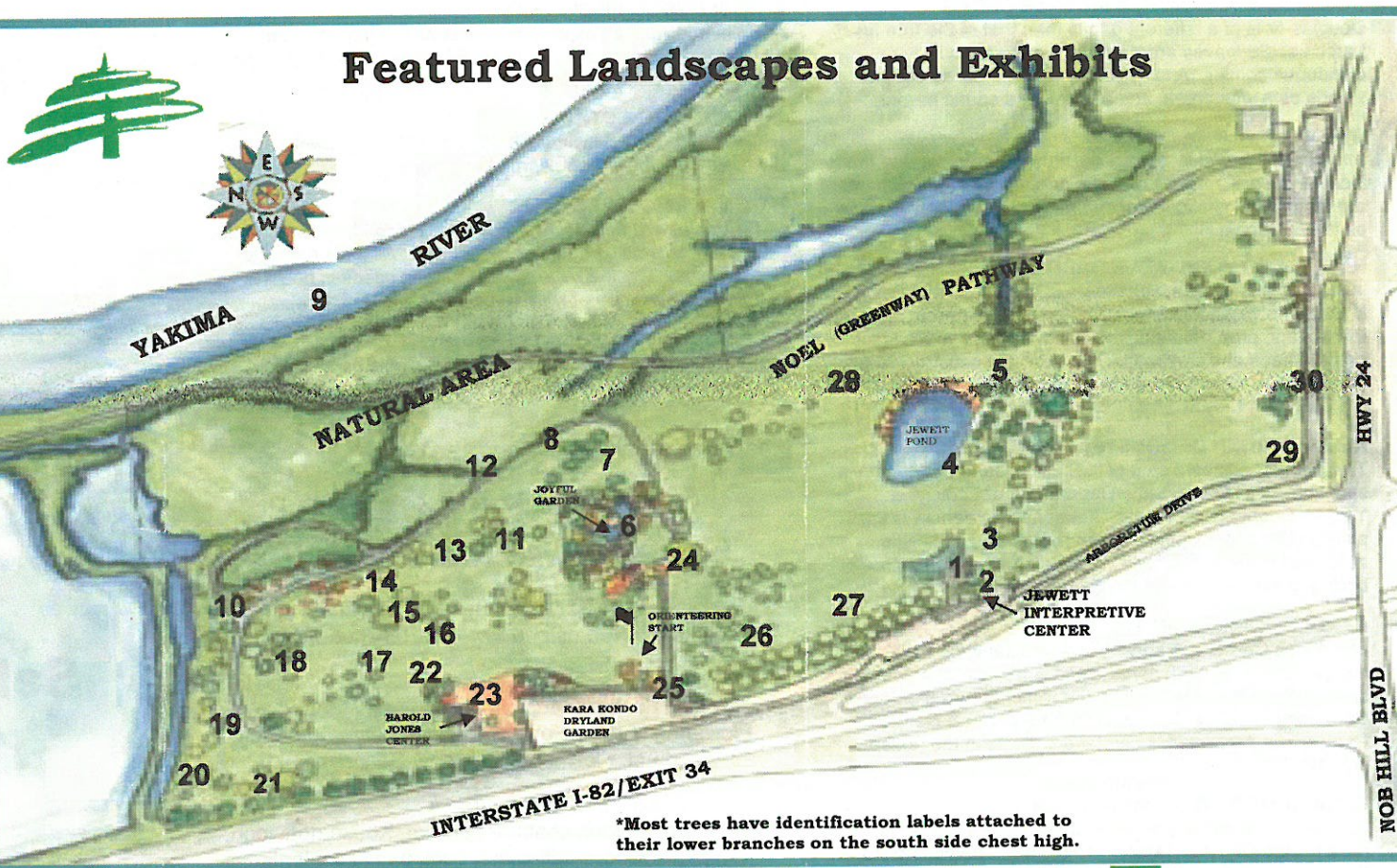

8 EDWARD M. SCHROEDER WETLAND TRAIL
From its trailhead, this path winds for 1/3-mile among native vegetation, crosses the Greenway Pathway and returns. Look for local wildlife, trees downed by beavers, bird houses, and the red bark of red osier dogwood.

9 YAKIMA RIVER
Flowing along the east edge of the Arboretum, the river is the water lifeline of the Valley. Native black cottonwood trees abound beside the river. Bald eagles can often be seen perched high in the trees.

10 NORTHEAST BRUSHLANDS
Here the wild brush and brush piles, alive and dead, offer prime habitat for birds and small animals.

11 LINDEN COLLECTION
Lindens are popular shade trees. The pervasive fragrance of flowering lindens attracts bees.

12 VIBURNUM
Many viburnums have showy flowers, thick foliage and brilliantly colored fruit. Migrating birds are attracted for food and shelter.

13 TREES OF WASHINGTON
Dedicated on Arbor Day 1997 to Knut Lunnum, this exhibit features native trees which are capable of withstanding the extremes of Yakima's temperate continental climate (from -25° F to + 110° F).

14 CARLSON BUTTERFLY GARDEN
This memorial to Barbara L. Carlson incorporates plantings of perennials and host plants in garden beds among dogwoods which are attractive to butterflies.

15 LIVING FOSSIL
The dawn redwood, a prehistoric tree, existed 50 million years ago, and shared landscapes with dinosaurs.

dinosaurs. Thought to have been extinct, it was rediscovered in 1941 in a remote area of western China. An expedition there in 1944 by the Arnold Arboretum has resulted in worldwide propagation and distribution of the species.

16 GIANT SEQUOIA COLLECTION
A small grove is making thrifty, symmetrical growth. This species is the most massive of trees, with great swollen red trunks and handsome pyramidal shape. A cold-tolerant tree from the high western slope of the Sierra Nevada, giant sequoia in the distant past grew in this area along with ginkgo and cypress.

17 HAWTHORN COLLECTION
Both thorned and thornless species provide cover and berries, called haws, for birds.

18 SWEETGUM COLLECTION
Fall foliage is exquisite for the range of color. Each of these trees was planted as a living memorial. Learn more about honoring loved ones with memorial trees by contacting the Interpretive Center.

19 SPRUCES & PINES
Several evergreen conifers are represented here, including spruces with pendulous cones and pines with woody cones.

20 FIRS
True firs exhibit symmetrical profiles. Generally their foliage is 'softer,' less rigid and prickly, than that of spruces. The cones grow upright and erect, and disintegrate after maturity, rather than falling intact as do those of spruce, Douglas-fir and most pines. (OVER)

Membership

☐ New ☐ Renewal ☐ Gift

Level of Membership

☐ Pine (Individual) \$30 ☐ Best Friend \$300
☐ Fir (Family) \$50 ☐ Cedar \$500 +
☐ Spruce \$100 ☐ Other _____
☐ Business \$200

☐ Honorary Donation \$ _____

Gift Membership or Honorary for

Name: _____

Address: _____

City/State/Zip: _____

Phone: _____ Email: _____

☐ In addition, I would like to make a tax-deductible gift to the Arboretum in the amount of \$ _____

Payment Information

Name: _____

Address: _____

City/State/Zip: _____

Phone: _____ Email: _____

Method of Payment:

☐ Check ☐ MasterCard ☐ Discover ☐ Visa
Acct. No. _____ Exp. Date: _____

☐ Please send me information on Memorials.

☐ I am interested in volunteering for an event or special project.

The Yakima Area Arboretum
Phone: (509) 248-7337 • Email: info@ahrtrees.org